

Pure
LIGHTING

© 2010 Pure Lighting. All Rights Reserved.

Stratus Installation Instruction

1718 W. Fullerton Ave
Chicago, IL 60614
Tel: 773-770-1195
Fax: 773-935-5613
www.purelighting.com
info@purelighting.com

PART# SH _SP _

IMPORTANT INFORMATION

- This product is suitable for indoor wet locations.
- This instruction shows a typical installation.
- This product is ETL listed.

SAVE THESE INSTRUCTIONS!

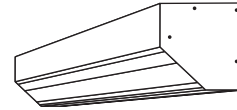

Install the Fixture

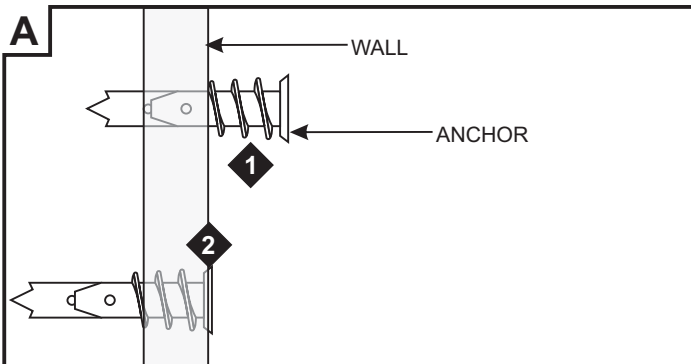

NOTE: Use the fixture as a template, by aligning it against the wall, ceiling, and the electrical conduit(s), and mark the necessary holes for installation. Punch out the marked knockout holes. Refer to the hole identification drawing on page 2 for proper installation.

- 1: Tap the anchors onto the marked locations up to the threaded portion with a hammer.
- 2: Screw the threaded portion of the anchors in with a Phillips screwdriver.

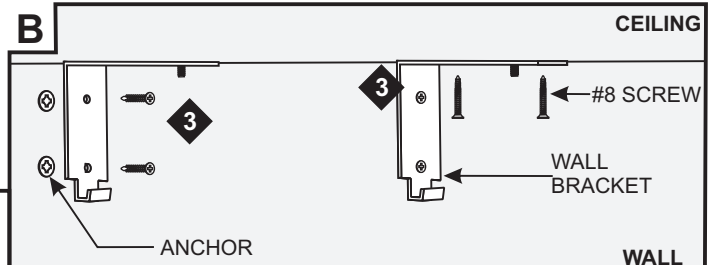

- 3: Mount each wall bracket onto the anchors and secure it with the provided four #8 screws.

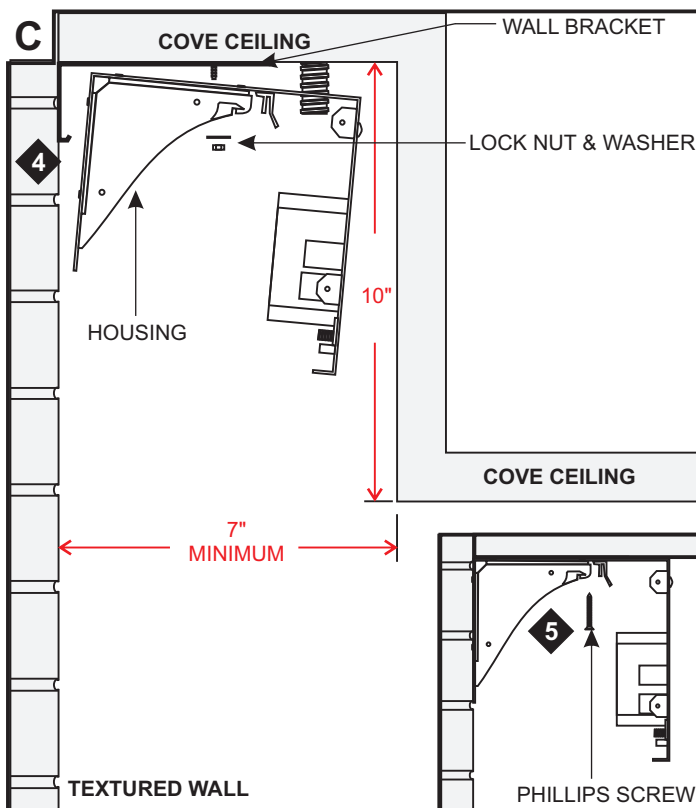

- 4: Align the fixture to the wall bracket and secure to the wall bracket with the lock nut and washer.
- 5: **OPTIONAL:** Secure the bracket to the ceiling with the #8 screws provided.

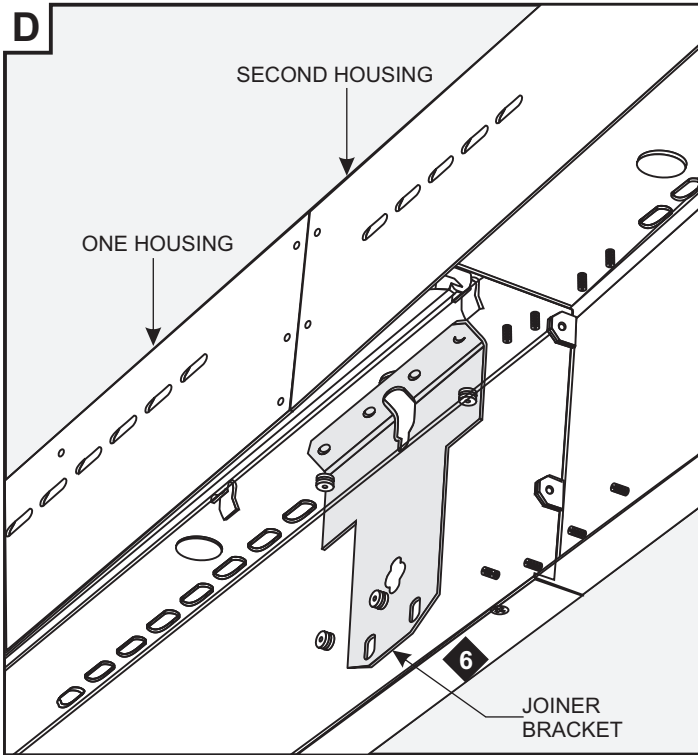

- 6: Use the additional provided joiner bracket, when joining two fixtures together.
- 7: Follow step 1 through 6 to install the remaining fixtures.
- 8: Make all the proper wire connection following the wiring diagram on page 3.

- 9: Insert the top portion of the LED panel into the bracket slot. Slide the bottom portion onto the fixture threaded stud and tighten the thumb nuts to secure it in place.
- 10: Follow wiring diagram on page 3 for proper wiring.

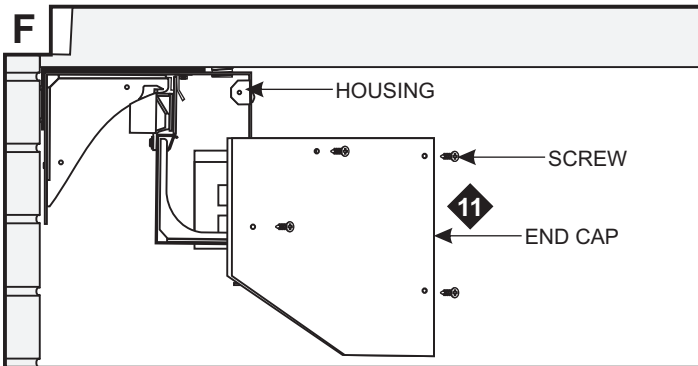
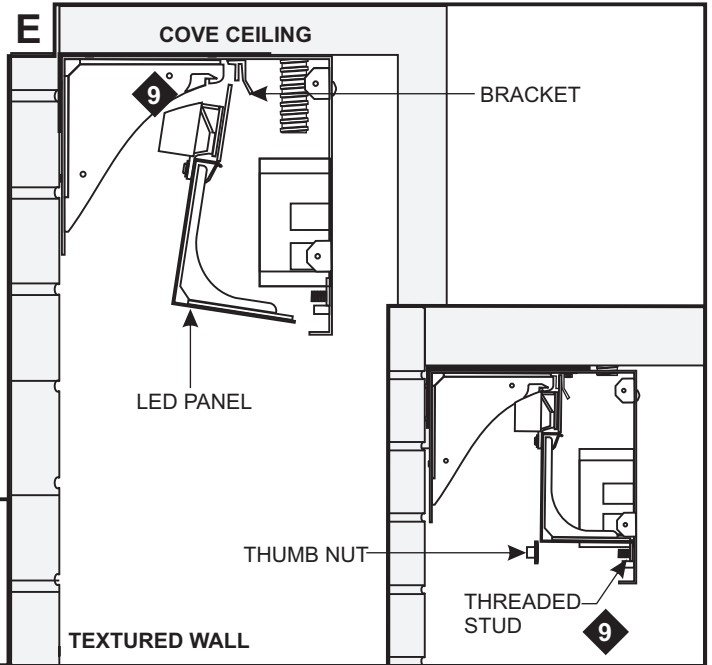

- 11: Secure the end caps to the housing with the four screws provided.

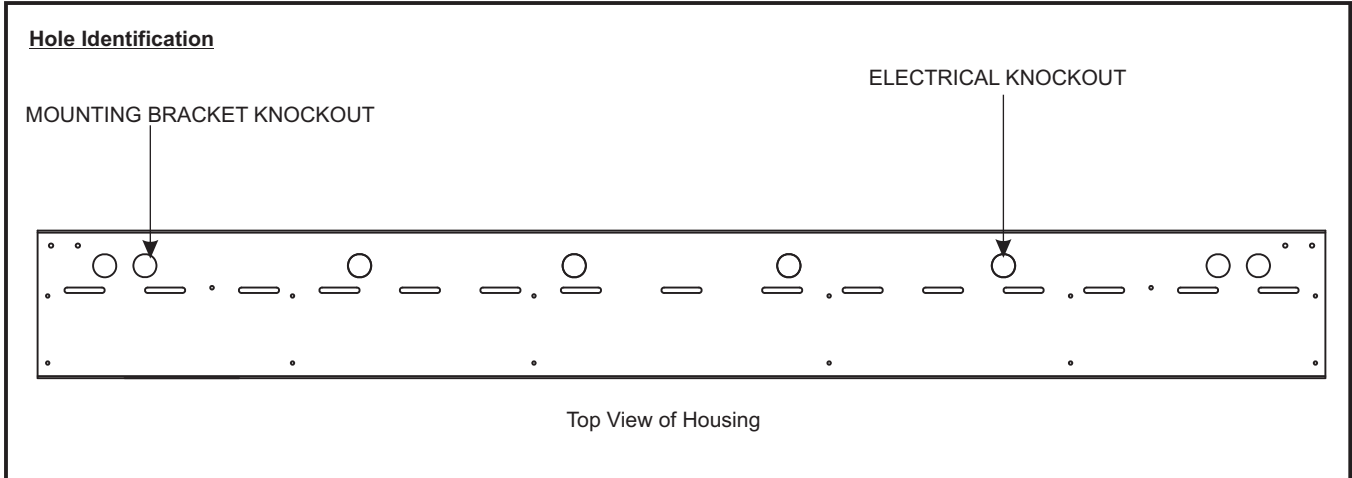

STRATUS LED WALL GRAZER- WIRING DIAGRAM

